

PLU_HJL107_175

Standard løsning:
 Alu vinkler og alu-afdækning er tilvalg.
 Træ stolpe og øvrige montage materialer leveres af montør.
 149 mm karm - 50x50 mm.
 175 mm karm - 75x75 mm.
 Opklodsning, skrueafstande og skrueplacering som standard montage.

Standard solution:
Continuous support profile and alu-flashing is optional.
Timber post and other installation materials by instaler.
 149 mm frame - 50x50 mm.
 175 mm frame - 75x75 mm.
 Wedging, fixing points and fixing areas as standard installation.

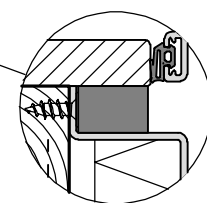

Alternativ løsning:
 Alu-afdækning er tilvalg.
 Special tilskårede træstolper er tilvalg.
 Nogle af typerne kan bestilles ved Idealcombi.
 Øvrige montage materialer leveres af montør.
 149 mm karm - 76.5x76.5 mm.
 175 mm karm - 102.5x102.5 mm.
 Skrueafstande og -placering som standard montage.

Alternative solution:
Alu-flashing is optional.
 Special cut wooden post is optional.
 Some of the types can be ordered by Idealcombi.
 Other installation materials by instaler.
 149 mm karm - 76.5x76.5 mm.
 175 mm karm - 102.5x102.5 mm.
 Fixing points and fixing areas as standard installation.

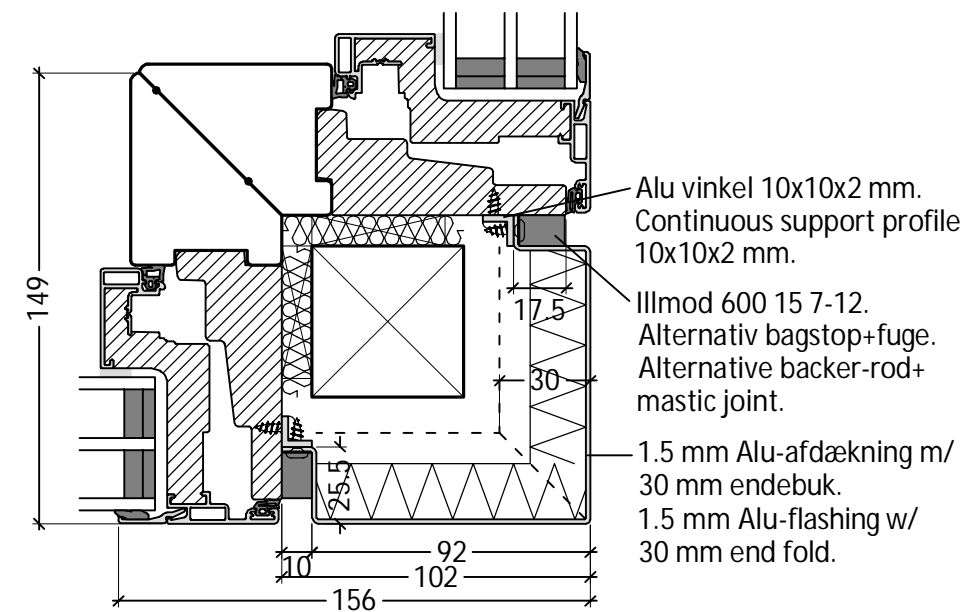

PLU_HJL107_149

DK	Standard hjørneløsning 90° 149/175 mm karm med smigskæring	www.idealcombi.dk
UK	Standard corner solution 90° 149/175 mm bevelled frame	www.idealcombi.com